



REMINGTON

REMINGTON®

ROTARY SHAVER FLEX AND PIVOT TECHNOLOGY

All technical modifications reserved. 08.08.TSC.08.06.17

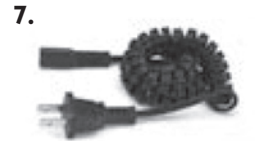

11/UK/R3150 Version 05/11 Part No. T22-32311
Remington® Registered Trademark of Spectrum Brands, Inc.,
or one of its subsidiaries
VARTA Consumer Batteries GmbH & Co. KGaA
Alfred-Krupp-Str. 9
73479 Ellwangen
Germany
www.remington-europe.com
© 2010 SBI



R3150





➔ **REMINGTON® SERVICE HOTLINES**

United Kingdom

☎ +44 0800 212 438 (free call)

Spectrum Brands (UK) Limited,
Fir Street, Failsworth,
Manchester,
M35 0HS, UNITED KINGDOM

www.remington.co.uk

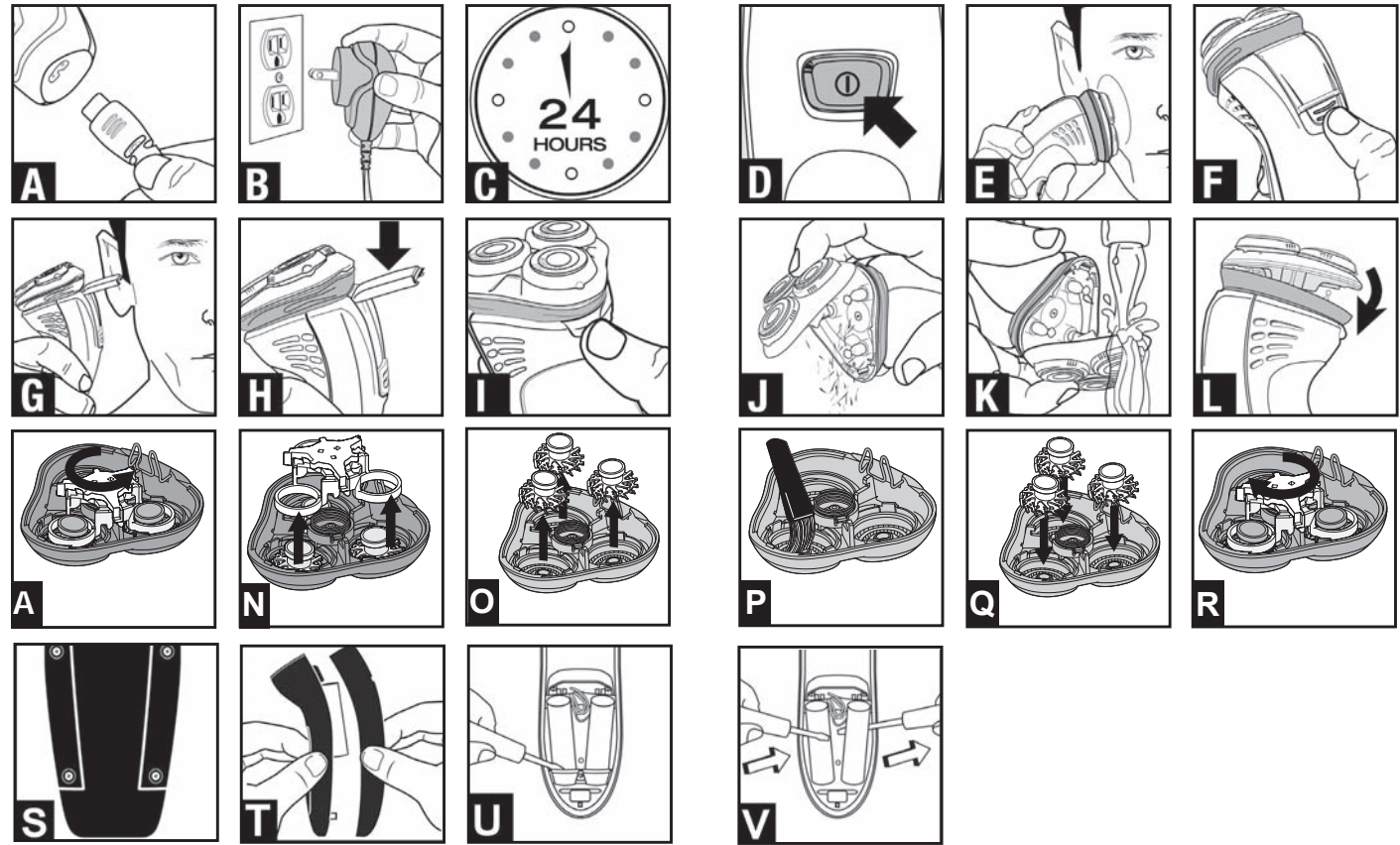



ENGLISH

Thank you for choosing Remington®. Our products are designed to meet the highest standard of quality, functionality and design. We hope you enjoy using your new Remington® product. Please read the instructions for use carefully and keep them in a safe place for future reference.



CAUTION

- ◆ Use this appliance only for its intended use as described in this manual.
- ◆ Do not use this product if it is not working correctly, if it has been dropped or damaged, or dropped into water.



DESCRIPTION

1. Pivoting Head & cutter assembly
2. Head release button
3. Individual flexing heads
4. On/Off Push button
5. Power port
6. Trimmer button
7. Power cord



GETTING STARTED

For best shaving performance, it is recommended that you use your new shaver daily for up to four weeks to allow time for your beard and skin to become accustomed to the new shaving system.

ENGLISH

■ CORDED USE

- ▶ Plug power cord into shaver (Fig. A).
- ▶ Plug power cord into wall outlet (Fig. B).
- ▶ Slide power switch up to turn on (Fig. D).
- ▶ Shave face and neck using short, circular strokes (Fig. E).
- ▶ Slide power switch down to turn off (Fig. D).

The shaver adapts automatically to a mains voltage between 100V and 240V.



HOW TO USE

■ SHAVING

- ▶ Switch the shaver on (Fig. D).
- ▶ Use the trimmer to remove long hair first.
- ▶ Hold the shaving head so all three heads touch your face simultaneously (Fig. D). The independently floating heads will automatically adjust to the contours of your face.
- ▶ Stretch the skin with your free hand so the hairs stand upright.
- ▶ Only apply light pressure on the shaving head while shaving (pressing too hard can damage the heads and make them vulnerable to breakage).
- ▶ Use short, circular strokes.

■ TRIMMING

- ▶ Push the trimmer button down (Fig. F).
- ▶ Place trimmer at desired trim line for a quick, easy, professional trim. Hold the shaver as shown in the illustration (Fig. G).
- ▶ To retract and switch off the trimmer, push the trimmer lock button in and downwards (Fig. H).

👉 TIPS FOR BEST RESULTS

Ensure your skin is dry. Always hold the shaver at right angles to the skin so that all three heads are touching the skin with equal pressure. Use moderate to slow stroking movements. The use of short circular motions in stubborn areas may obtain a closer shave, especially along the neck and chin line. **DO NOT** press hard against the skin in order to avoid damage to the rotary heads.



CARE FOR YOUR SHAVER

Care for your product to ensure a long lasting performance. We recommend you clean your shaver after each use. Using a brush clean the internal parts of the head assembly and shaver body. Always keep the trimmer in the "off" position when the shaver is not in use.

ENGLISH

■ CLEANING DAILY

- ▶ Ensure the shaver is switched off and unplugged from the mains.
- ▶ Open the shaver head by pressing the release button on the front of the shaver (Fig. I).
- ▶ Tape out excess hair shavings (Fig. J).
- ▶ Close head assembly (Fig. K).

■ CLEANING WEEKLY

- ▶ Perform the daily cleaning steps first
- ▶ Open the shaver head by pressing the release button on the front of the shaver (Fig. I) and flipping open the head away from the body of the shaver (Fig. J).
- ▶ Release the inner cutter carrier by rotating the locking arms counter-clockwise (Fig. M)
- ▶ Pull the inner cutter carrier away from the inner cutters (Fig. N).
- ▶ Thoroughly brush hairs from the inner and outer cutters (Fig. P) and rinse out remaining debris .
- ▶ Replace inner cutter (Fig.O).
- ▶ Place the inner cutter carrier back onto the upper hairpocket and lock in place by rotating the locking arms clockwise until the arms 'click' into place (Fig. Q - R)

◆ CAUTION:

Never submerge your shaver in water.

■ CLEANING TRIMMER

- ▶ Lubricate the teeth of the trimmer every six months with one drop of sewing machine oil.

Replacement Part No. SP-SFD2



IMPORTANT SAFETY INSTRUCTIONS

WARNING – TO REDUCE THE RISK OF BURNS, ELECTROCUTION, FIRE, OR INJURY TO PERSONS:

- ▶ An appliance should never be left unattended when plugged in to a power outlet, except when charging.
- ▶ Keep the power plug and cord away from heated surfaces.
- ▶ Make sure the power plug and cord do not get wet.
- ▶ Do not plug or unplug the shaver with wet hands.
- ▶ Do not use the product with a damaged cord. A replacement can be obtained via the Remington® Service Center.
- ▶ Use and store the product at a temperature between 0°C and 32°C.
- ▶ Only use the parts supplied with this appliance. Use of non Remington parts with this product may give rise to a hazardous condition.
- ▶ Do not submerge or place under running water.
- ▶ Keep this product out of reach of children. The use of this appliance by persons with reduced physical, sensory or mental capabilities or lack of experience and knowledge can give cause to hazards. Persons responsible for their safety should give explicit instructions or supervise the use of the appliance.

ENGLISH



PROTECT THE ENVIRONMENT

Do not dispose of the shaver in the household waste at the end of useful life. Disposal can take place at the Remington® Service Center or appropriate collection sites.



■ For further information on recycling see www.remington-europe.com



SERVICE AND WARRANTY

This product has been checked and is free of defects. We warrant this product against any defects that are due to faulty material or workmanship for a 2 year period from the original date of consumer purchase. If the product should become defective within the warranty period, we will repair any such defect or elect to replace the product or any part of it without charge provided there is proof of purchase.

This does not mean an extension of the warranty period. In the case of a warranty simply call the Remington® Service Center in your region.

This warranty is offered over and above your normal statutory rights. The warranty shall apply in all countries in which our product was sold via an authorised dealer.

This warranty does not include shaving heads / foils and cutters which are consumable parts. Also not covered is damage to the product by accident or misuse, abuse, alteration to the product or use inconsistent with the technical and/or safety instructions required. This warranty shall not apply if the product has been dismantled or repaired by a person not authorised by us.